

## PN25

## IRON GATE VALVE

Bolted bonnet, outside screw & yoke, flanged ends

25Bar/2.5MPa, W.O.G—10~120°C Saturated Steam



Fig. (PHOX)EN25FCLE

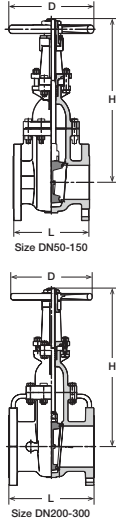

### Materials

Parts	Material	Specifications
Body	Cast Iron	EN1561 EN-GJL-250
Bonnet	Cast Iron	EN1561 EN-GJL-250
Stem	Forged Brass	BS2874 CZ122
Disc	Cast Iron	EN1561 EN-GJL-250
Body seat ring	Cast Bronze	BS1400 LG2
Disc seat ring	Cast Bronze	BS1400 LG2
Gland	Ductile Iron	
Gland packing	Graphite	
Gasket	Non-Asbestos	
Gland bolt/nut	Carbon Steel	
Bonnet bolt/nut	Carbon Steel	
Yoke bush	Cast Brass	
Hand wheel	Cast Iron	EN1561 EN-GJL-250

### Design Specifications

Items	
Shell wall thickness and general valve design	Manufacturers standard
Face-to-face/End-to-end dimensions	EN558-1 series 4
End flange dimensions Gasket contact facing	EN1092-2 PN25

### Dimensions

Valve Size	NPS	2	2½	3	4	5	6	8	10	12
	DN	50	65	80	100	125	150	200	250	300
L Face-to-face		215.9	241.3	282.5	304.8	381	403.2	419.1	457	502
H Height (OPEN)		385	437	493	611	716	813	1023.5	1211	1386
D Handwheel Diameter		175	200	254	300	300	348	400	457	457

## PN16

## IRON GLOBE VALVE

Bolted bonnet, Outside screw & yoke, Rising stem, Flanged ends.

16 bar at 120°C, 12.8 bar at 200°C, P-T rating : See page 01

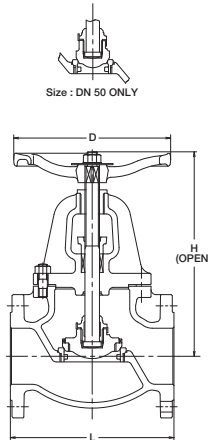

Fig. EN16FCJ

• Bronze trim

Fig. EN16FCJM

• Stainless steel trim



### Materials

Parts	Material	Specifications	
		EN16 FCJ	EN16FCJM
Body	Cast Iron	EN-GJL-200	
Bonnet	Cast Iron	EN-GJL-200	
Stem	Forged Brass	JIS H3250 C3771BD or BE	ASTM A276 Type316
Disc	DN 50 only	Stainless Steel	JIS H5120 CAC406   ASTM A351 Gr.CF8M
	DN 65 to 250	Cast Iron	EN-GJL-200
Disc seat ring	Cast Bronze	JIS H5120 CAC406	ASTM A182 Gr.F316
Body seat ring	Cast Bronze	JIS H5120 CAC406	ASTM A182 Gr.F316
Gland		Ductile Iron	
Gland packing		Flexible Graphite + PTFE Braided	
Gasket		Graphite	
Gland bolt/nut		Carbon Steel	
Bonnet bolt/nut		Carbon Steel	
Yoke bush		Cast Bronze	
Hand wheel	DN 50 to 150	Cast Iron	
	DN 200 & 250	Ductile Iron	

### Design Specifications

Shell wall thickness	KITZ Standard
Face-to-face or End-to-end dimensions	EN 558 PN16 Basic Series 10
End Connection	EN 1092-2 PN16

### Dimensions

Valve Size	NPS	2	2½	3	4	5	6	8	10
	DN	50	65	80	100	125	150	200	250
L Face-to-face		203	216	241	292	330	356	495	622
H Height (OPEN)		277	307	353	404	467	533	620	665
D Handwheel Diameter		180	180	225	280	300	350	450	450